

HUNT FRAME

ESTATE AGENTS



3 13 St. Aubyns Road, Eastbourne, BN22 7AS

£130,000



A second (top) floor flat located close to Eastbourne seafront. Currently let at £1000 per calendar month. Viewing is highly recommended.



Communal front door with security entry phone to:

Communal Hallway
Stairs to first floor, front door to:

Entrance Hall
Stairs up to top floor.

Landing

Radiator, security entry phone, built in cupboard.

Lounge

13 x 12'1 (3.96m x 3.68m)
Radiator, double glazed window to front, wood effect flooring.

Kitchen

9'1 x 5 (2.77m x 1.52m)
Fitted in a range of wall and base mounted cupboards and drawers. Inset circular sink and single drainer unit. Built in oven, hob and extractor. Space and plumbing for washing machine, space for fridge/freezer, double glazed window to front.

Bedroom One

11'9 x 11'6 (3.58m x 3.51m)
Radiator, double glazed window to rear.

Bedroom Two

9 x 8'2 (2.74m x 2.49m)
Radiator, double glazed window to rear.

Bathroom

In a white suite comprising panelled bath with shower above, wash basin and low level wc, heated towel rail.

NB A section 13 rent increase has been served to increase the rent to £1000 per month.

Lease: 125 years from 11th January 2008

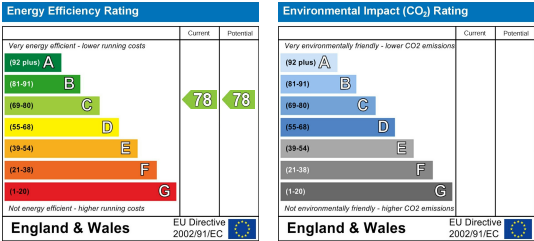
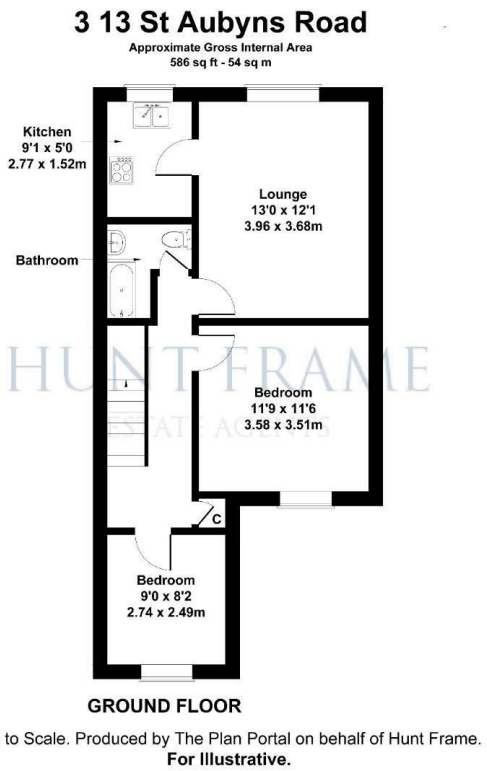

These particulars, whilst believed to be accurate are set out as a general outline only for guidance and do not constitute any part of an offer or contract. Intending purchasers should not rely on them as statements of representation of fact, but must satisfy themselves by inspection or otherwise as to their accuracy. No person in this firms employment has the authority to make or give any representation or warranty in respect of the property.